



# CD106

## Alignment Coupler

Not to be used outside of clinic.



Weight Limit 265 lbs.

2-Year warranty against manufacturer defects, excessive wear or breakage.  
External Prosthetic Components



EC REP

Advena Limited  
Tower Business Centre  
2nd Flr, Tower Street  
Swatar, BKR 4013  
Malta

CD106.revA.11072022

**Included in package:** CD106 Alignment Coupler  
(four) 6mm x 25 mm flat head screws to install  
Alignment Coupler to socket.  
(four) 6mm x 14mm flat head screws to install endo components to alignment coupler.  
The counter sink slide fits to the socket.  
The threaded side fits to the endo components.  
Torque settings for 3mm adjustment screws is 5Nm.  
Torque settings of 6mm flat socket head cap screw is 10Nm.

Offset for ML and AP of 0.64". Easily installs on four hole connector. Easy to adjust with 3mm wrench.

**For in house fitting and alignment purposes only**  
**not to be used outside of facility.**

265 lb. weight limit.

EN | Instructions for Use  
DE | Gebrauchsanweisung  
FR | Notice d'utilisation  
ES | Instrucciones para el uso  
IT | Istruzioni per l'uso  
NO | Bruksanvisning  
DA | Brugsanvisning  
SV | Bruksanvisning  
EL | Οδηγίες Χρήσης  
FI | Käyttöohjeet  
NL | Gebruiksaanwijzing  
PT | Instruções de Utilização

PL | Instrukcja użytkowania  
CS | Návod k použití  
TR | Kullanım Talimatları  
RU | Инструкция по использованию  
JA | 取扱説明書  
ZH | 中文说明书  
KO | 사용 설명서



[www.coyote.us/instructions-connectors](http://www.coyote.us/instructions-connectors)



# CD106

## Alignment Coupler

Not to be used outside of clinic.



Weight Limit 265 lbs.

2-Year warranty against manufacturer defects, excessive wear or breakage.  
External Prosthetic Components



EC REP

Advena Limited  
Tower Business Centre  
2nd Flr, Tower Street  
Swatar, BKR 4013  
Malta

CD106.revA.11072022

**Included in package:** CD106 Alignment Coupler  
(four) 6mm x 25 mm flat head screws to install  
Alignment Coupler to socket.  
(four) 6mm x 14mm flat head screws to install endo components to alignment coupler.  
The counter sink slide fits to the socket.  
The threaded side fits to the endo components.  
Torque settings for 3mm adjustment screws is 5Nm.  
Torque settings of 6mm flat socket head cap screw is 10Nm.

Offset for ML and AP of 0.64". Easily installs on four hole connector. Easy to adjust with 3mm wrench.

**For in house fitting and alignment purposes only**  
**not to be used outside of facility.**

265 lb. weight limit.

EN | Instructions for Use  
DE | Gebrauchsanweisung  
FR | Notice d'utilisation  
ES | Instrucciones para el uso  
IT | Istruzioni per l'uso  
NO | Bruksanvisning  
DA | Brugsanvisning  
SV | Bruksanvisning  
EL | Οδηγίες Χρήσης  
FI | Käyttöohjeet  
NL | Gebruiksaanwijzing  
PT | Instruções de Utilização

PL | Instrukcja użytkowania  
CS | Návod k použití  
TR | Kullanım Talimatları  
RU | Инструкция по использованию  
JA | 取扱説明書  
ZH | 中文说明书  
KO | 사용 설명서



[www.coyote.us/instructions-connectors](http://www.coyote.us/instructions-connectors)



Manufactured by Coyote®  
419 N. Curtis Rd., Boise, Idaho 83706  
(208) 429-0026 | [www.coyote.us](http://www.coyote.us)



Manufactured by Coyote®  
419 N. Curtis Rd., Boise, Idaho 83706  
(208) 429-0026 | [www.coyote.us](http://www.coyote.us)



## Transferring Alignment - Instruction example from Air-Lock

When transferring, it is recommended to use a new lock or lock housing in the definitive socket. The lock in the test socket can be removed when time permits and reused in another test socket. This will also allow you to duplicate the alignment established in the test socket in the definitive.

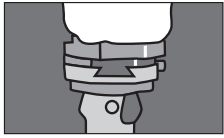

**27** Use Coyote alignment coupler CD106 for alignment during fitting.



**28** Lube and install glue plate on Coyote Alignable Connector.

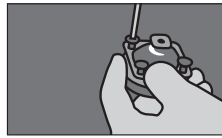

**29** Attach a pyramid to Coyote Alignable Connector.

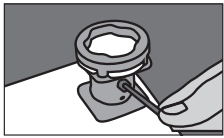

**30** Install pyramid on adaptor.



**31** Install lock on mold in desired location, mark release button location. (See Caution #1).

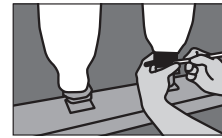

**32** Rest mold and lock on Alignable Connector. Place test socket next to mold and compare alignments.

**33** Take measurements for more accurate comparisons.

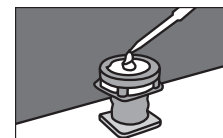

**34** Separate lock from connector. Fill connector with Coyote Quik Glue or fast-setting epoxy.



**35** Place mold and lock back into connector in desired location. Let set.



**36** Remove pyramid from tube clamp then remove pyramid and glue plate.



**37** Remove all lock parts before laminating. Put wax or clean clay in fabrication plug hole.

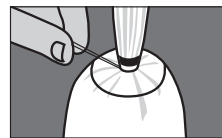

**38** Pull inner PVA bag over mold. Bag may be heated to help conform to distal end. Tie PVA to anchor in the tie-off ring.

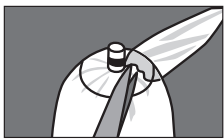

**39** Trim excess PVA material between tie-off groove and o-ring. Keep o-rings clear.



**40** Run bead of Coyote Quik Glue or five minute epoxy around funnel of lock.

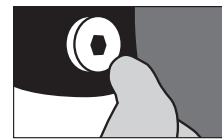

**41** Place lock on anchor in desired location (see Caution #1). Clean excess glue.

### ATTENTION

1. Do not position lock with release button pointing posterior or anterior. Typically release button is oriented medially to help avoid being triggered.
2. Typical Coyote® components use 6x18mm screws. In atypical setups, longer screws may be needed. Always use screws class 10.9 or better.
3. Do not lubricate inside of lock, this will attract debris. If you have a noise issue, it is typically due to seating. Call for technical assistance.
4. Always use screws provided with connector during lamination to ensure proper depth is created for attachment.

## Transferring Alignment - Instruction example from Air-Lock

When transferring, it is recommended to use a new lock or lock housing in the definitive socket. The lock in the test socket can be removed when time permits and reused in another test socket. This will also allow you to duplicate the alignment established in the test socket in the definitive.

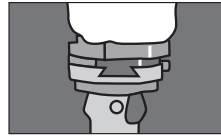

**27** Use Coyote alignment coupler CD106 for alignment during fitting.



**28** Lube and install glue plate on Coyote Alignable Connector.

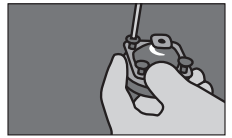

**29** Attach a pyramid to Coyote Alignable Connector.

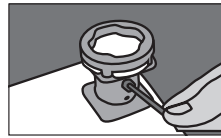

**30** Install pyramid on adaptor.



**31** Install lock on mold in desired location, mark release button location. (See Caution #1).

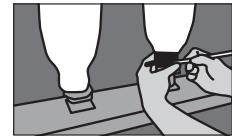

**32** Rest mold and lock on Alignable Connector. Place test socket next to mold and compare alignments.

**33** Take measurements for more accurate comparisons.

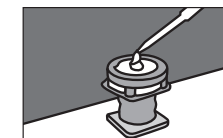

**34** Separate lock from connector. Fill connector with Coyote Quik Glue or fast-setting epoxy.



**35** Place mold and lock back into connector in desired location. Let set.



**36** Remove pyramid from tube clamp then remove pyramid and glue plate.



**37** Remove all lock parts before laminating. Put wax or clean clay in fabrication plug hole.



**38** Pull inner PVA bag over mold. Bag may be heated to help conform to distal end. Tie PVA to anchor in the tie-off ring.

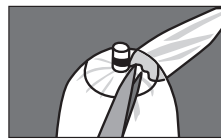

**39** Trim excess PVA material between tie-off groove and o-ring. Keep o-rings clear.



**40** Run bead of Coyote Quik Glue or five minute epoxy around funnel of lock.

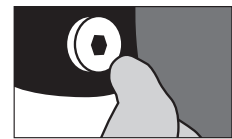

**41** Place lock on anchor in desired location (see Caution #1). Clean excess glue.

### ATTENTION

1. Do not position lock with release button pointing posterior or anterior. Typically release button is oriented medially to help avoid being triggered.
2. Typical Coyote® components use 6x18mm screws. In atypical setups, longer screws may be needed. Always use screws class 10.9 or better.
3. Do not lubricate inside of lock, this will attract debris. If you have a noise issue, it is typically due to seating. Call for technical assistance.
4. Always use screws provided with connector during lamination to ensure proper depth is created for attachment.